

0cm 1cm 2cm 3cm 4cm 5cm

A-1

1/8 3/8 5/8 7/8 1in 2in 3in

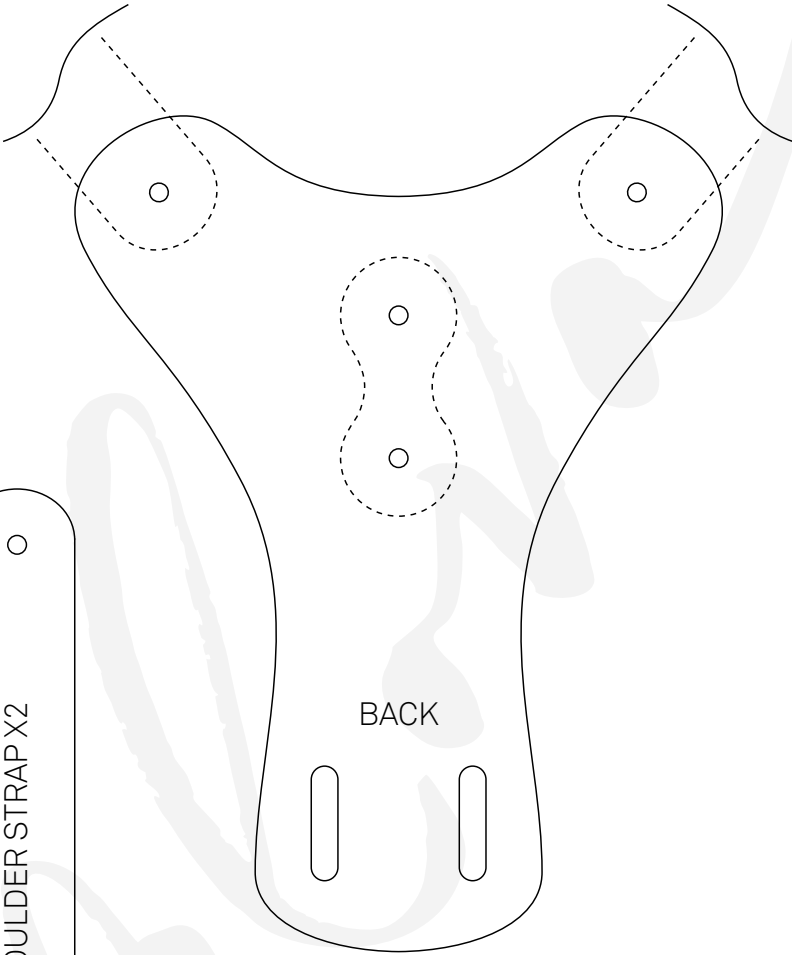

0cm 1cm 2cm 3cm 4cm 5cm

B-1

1/8 3/8 1/2 5/8 3/4 1in 2in 3in

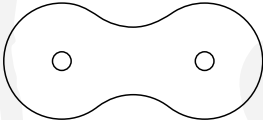
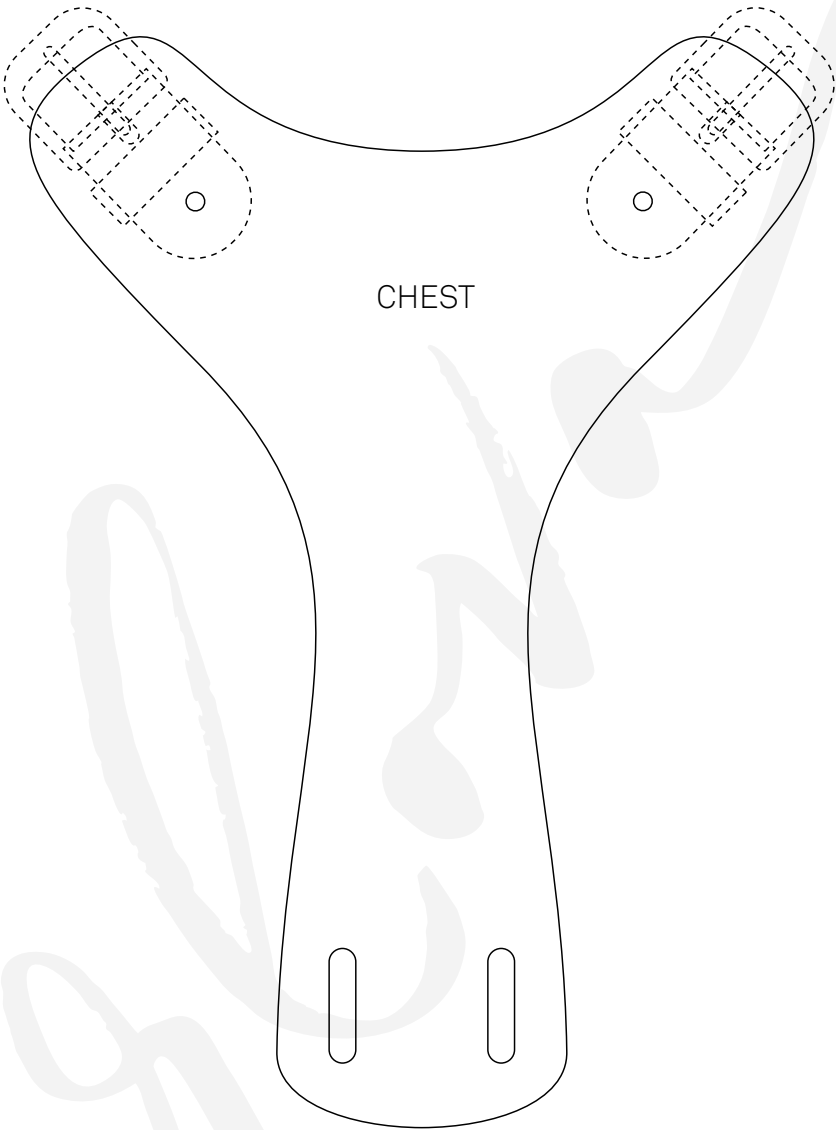

D-RING  
ATTACHMENT



STRAP KEEPER X3

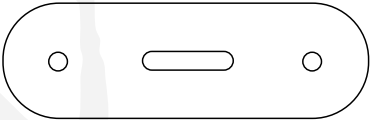

SHOULDER  
BUCKLE STRAPS X2

## Dog Harness 1



This is a harness for small dogs (chihuahua, toy terrier, yorkie, all the miniature pups) that weigh around 4-6 pounds and have girth around 10-13 inches. You can adjust the length of the straps according to your dog's measurements.

**Materials:**

I recommend using 2-3 oz leather (veg or chrome) with medium temper. But you might try different materials to see how they work.

**Hardware:**

3 x 5/8 buckles

1 x 3/8 D-ring

Rivets

**Tools:**

Scissors, knife.

Mallet, rivet setter, hole punchers (round for rivets and oblong for buckles).

**Instructions:**

Print the pattern at actual size (100%). Use the reference on top of each page to make sure everything is printed correctly. Join the pages together.

Any questions or comments, e-mail me: [lissius@gmail.com](mailto:lissius@gmail.com).